



JAMIE WARNER

— ESTATE AGENTS —



1 Victoria Road, Haverhill, CB9 9PS

Guide Price £400,000

- Four Bedrooms
- Attractive Fitted Kitchen
- Single Garage and Generous Parking
- Three Reception Rooms
- Landsaped Southerly Garden
- En Suite To Main Bedroom
- Cambridge Side Of Town

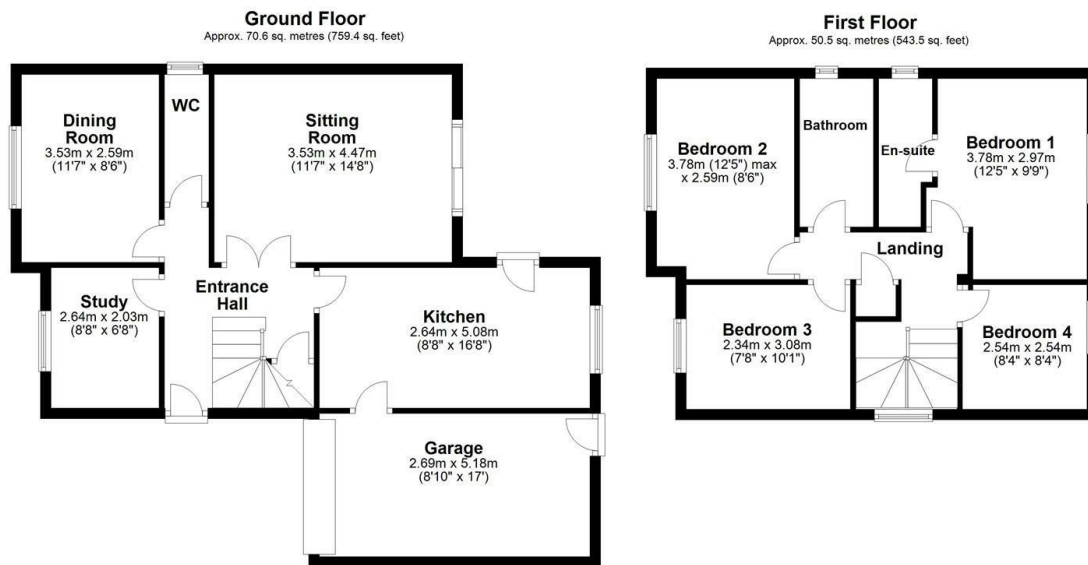

Total area: approx. 121.0 sq. metres (1302.9 sq. feet)

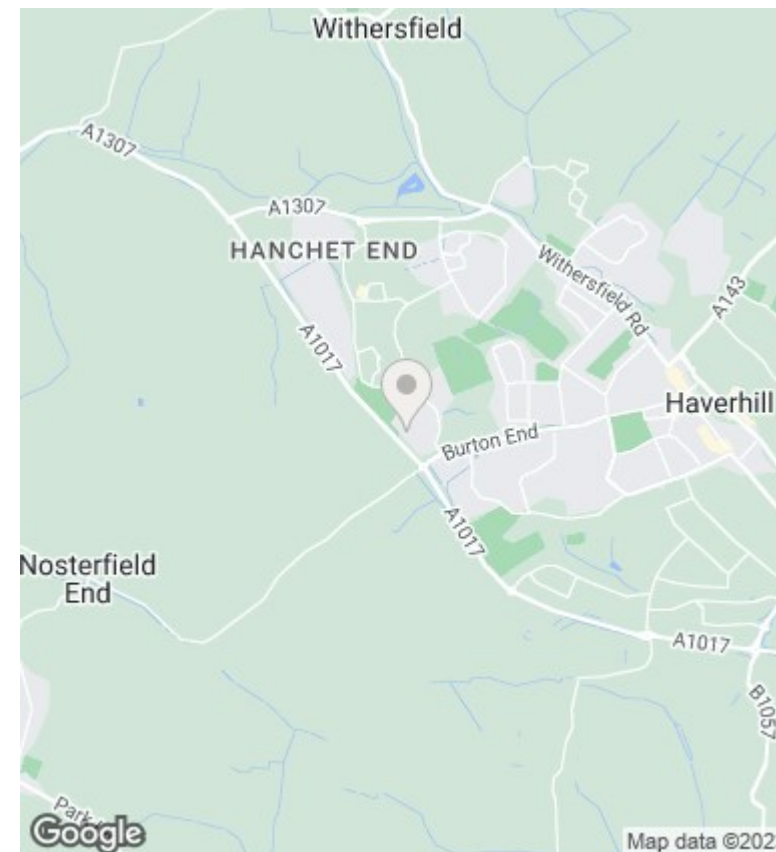

Directions

Viewings

Viewings by arrangement only. Call 01440 712221 to make an appointment.

Council Tax Band

EPC Rating:

Energy Efficiency Rating		
	Current	Potential
<i>Very energy efficient - lower running costs</i>		
(92 plus) A		
(81-91) B		
(69-80) C		
(55-68) D		
(39-54) E		
(21-38) F		
(1-20) G		
<i>Not energy efficient - higher running costs</i>		
England & Wales	EU Directive 2002/91/EC	